

# DETACHED GARAGE (TYPICAL)

## PLANNING AND DEVELOPMENT DEPARTMENT CITY OF DIEPPE

**Note:** Please consult with the Planning and Development Department if the building exceeds 55 sq. m (592 sq. ft.) or has a 2<sup>nd</sup> floor.

**Proposed use of building:**

**For internal use only**

Date received \_\_\_\_\_

Application number \_\_\_\_\_

Indicate dimensions of building, show location and size of openings for windows and doors on building plan.

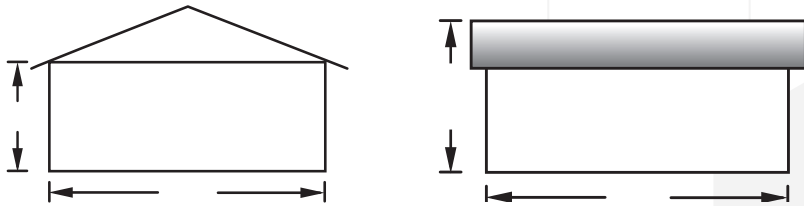

### 1. ROOF

- Roofing material: \_\_\_\_\_
- Sheathing (type and thickness): \_\_\_\_\_
- Roof structural system:
  - Pre-fabricated trusses by manufacturer
  - Fabricated trusses by owner / contractor
  - Rafter construction
    - Size / grade: \_\_\_\_\_ Spacing: \_\_\_\_\_
- Insulation (type and R-value): \_\_\_\_\_
- Strapping (type, size and spacing): \_\_\_\_\_
- Vapour barrier (type and thickness): \_\_\_\_\_
- Ceiling finish (type and thickness): \_\_\_\_\_

### 2. WALL

- Exterior cladding (type): \_\_\_\_\_
- Air barrier (type): \_\_\_\_\_
- Sheathing (type and thickness): \_\_\_\_\_
- Stud (size and spacing): \_\_\_\_\_
- Insulation (type and R-value): \_\_\_\_\_
- Vapour barrier (type and thickness): \_\_\_\_\_
- Finish (type and thickness): \_\_\_\_\_

### 3. FLOOR

- Thickness of concrete slab: \_\_\_\_\_
- Undisturbed soil:  yes  no

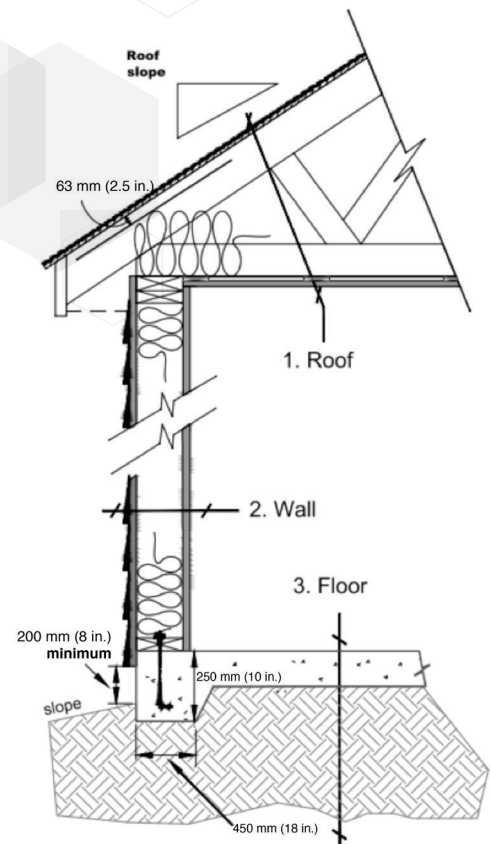

\_\_\_\_\_

Civic address / PID

\_\_\_\_\_

Telephone number

\_\_\_\_\_

Date

\_\_\_\_\_

Name(s) of owner(s) or authorized agent

\_\_\_\_\_

Signature(s) of owner(s) or authorized agent

Personal information on this form is collected under the authority of the *Right to Information and Protection of Privacy Act* for the purpose of processing your application. Questions about this collection of personal information can be directed to the City Clerk, 333 Acadie Avenue, Dieppe, New Brunswick, E1A 1G9, 506.877.7900.

