

DETACHED GARAGE (TYPICAL)

PLANNING AND DEVELOPMENT DEPARTMENT CITY OF DIEPPE

Note: Please consult with the Planning and Development Department if the building exceeds 58 sq. m (624 sq. ft.) or has a 2nd floor.

Proposed use of building:

For internal use only

Date received

Application number

Indicate dimensions of building, show location and size of openings for windows and doors on building plan.

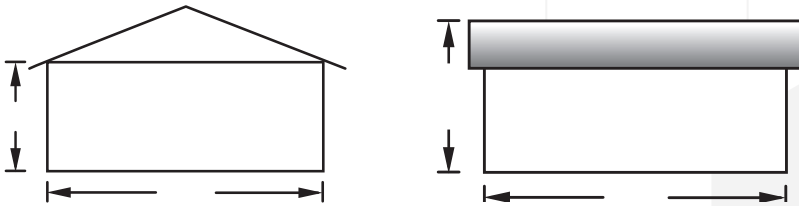

1. ROOF

- Roofing material: _____
 Sheathing (type and thickness): _____
 Roof structural system:
 Pre-fabricated trusses by manufacturer
 Fabricated trusses by owner / contractor
 Rafter construction
 • Size / grade: _____ Spacing: _____
 Insulation (type and R-value): _____
 Strapping (type, size and spacing): _____
 Vapour barrier (type and thickness): _____
 Ceiling finish (type and thickness): _____

2. WALL

- Exterior cladding (type): _____
 Air barrier (type): _____
 Sheathing (type and thickness): _____
 Stud (size and spacing): _____
 Insulation (type and R-value): _____
 Vapour barrier (type and thickness): _____
 Finish (type and thickness): _____

3. FLOOR

- Thickness of concrete slab: _____
 Undisturbed soil: yes no

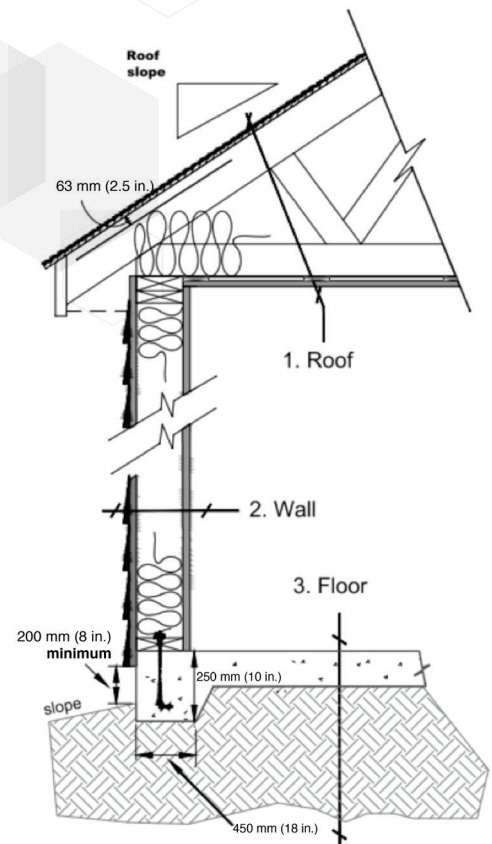

Civic address / PID

Name(s) of owner(s) or authorized agent

Telephone number

Signature(s) of owner(s) or authorized agent

Date

Personal information on this form is collected under the authority of the *Right to Information and Protection of Privacy Act* for the purpose of processing your application. Questions about this collection of personal information can be directed to the City Clerk, 333 Acadie Avenue, Dieppe, New Brunswick, E1A 1G9, 506.877.7900.



101PD11.16E